

SURVEY OF PROPERTY

Situate
Town Of East Hampton
Suffolk County, New York

SCALE: 1" = 50'

OVERALL LOT AREA:
409,552 sq. ft.
or 9.4020 acres

KEY MAP

1" = 600'

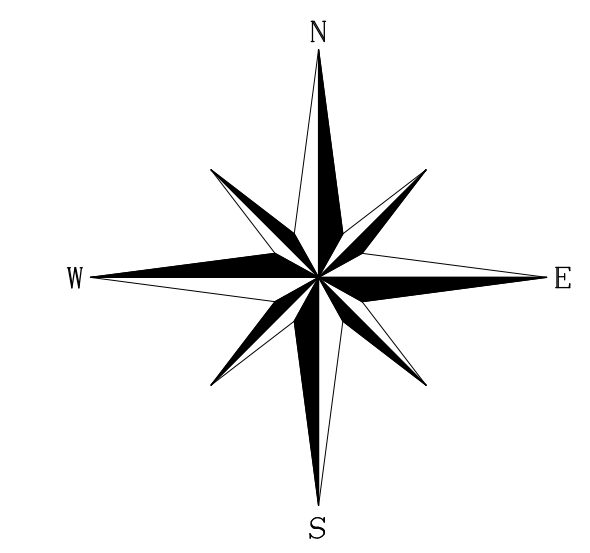
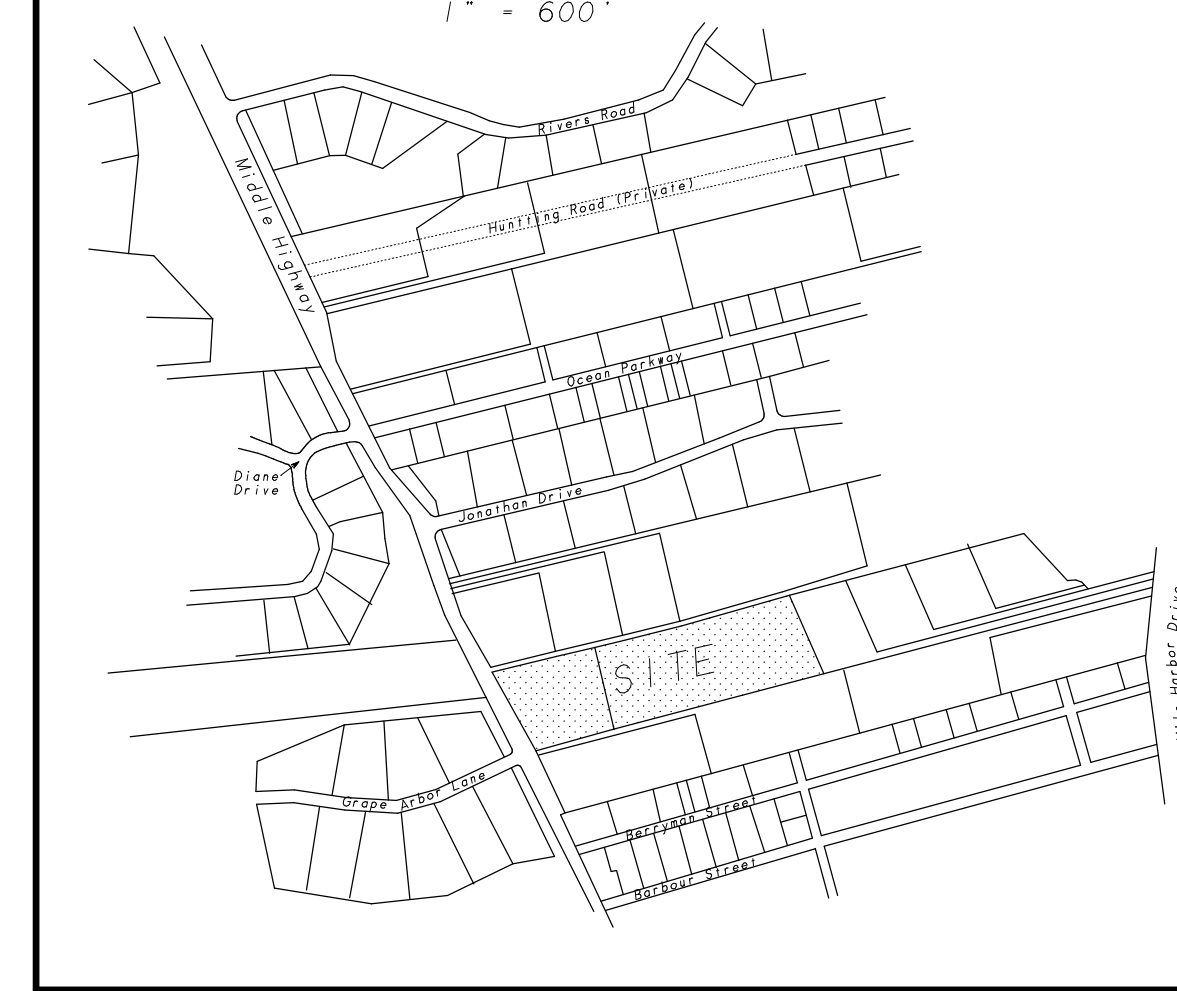

Jonathan Drive

R=25.00'
L=41.91'

SCTM No. 300-142-1-2.1
AREA: 130,683 sq. ft.
or 3.0001 acres

SCTM No. 300-142-1-2.2
AREA: 278,869 sq. ft.
or 6.4020 acres

ZONING DISTRICT: "A3" Residential
SCHOOL DISTRICT: East Hampton
FIRE DISTRICT: East Hampton

Certified only to:
Maggie Kotuk

LINE	BEARING	DISTANCE
L 1	N 28°03'16"W	20.65'
L 2	N 32°42'56"W	20.58'

- indicates found concrete monument.
- indicates found iron pin.
- indicates set 12" iron pin.

- NOTES:
1. Unauthorized alteration or addition to a survey map bearing a licensed land surveyor's seal is a violation of section 7209, subdivision 2 of the N.Y. State Education Law.
 2. Only copies from the original of this survey marked with an original of the land surveyor's embossed seal or inked seal shall be considered to be valid copies.
 3. Certifications indicated hereon signify that this survey was prepared in accordance with the existing Code of Practice for Land Surveys adopted by the N.Y. State Association of Professional Land Surveyors. Said certifications shall run only to the person for whom the survey is prepared, and on his behalf to the title company, governmental agency and lending institution listed hereon, and to the assignees of the lending institution. Certifications are not transferable to additional institutions or subsequent owners.
 4. Underground improvements or encroachments, if any, are not shown hereon.
 5. The existence of right of ways, wetlands and/or easements of record, if any, not shown are not guaranteed.

- August 4, 2010: Prepare composite map
- March 16, 2010: Plot attached shed
- January 22, 2010: Revise proposed parking area & calcs.
- November 5, 2009: Update & proposed parking
- October 6, 2009: Add existing sanitary
- April 27, 2009: Coverage calculations
- April 13, 2009: Update

Surveyed: October 25, 2002
David L. Saskas
N.Y.S. Lic. No. 049960

Saskas Surveying Company, P.C.
124 Cedar Street
East Hampton, New York 11937
(631) 324-6917 FAX 329-4768